



FEATURES:

Sizes: □ 1/2" □ 3/4" □ 1"

Maximum working pressure: 125psi

Maximum working water temperature: 180°F

APPLICATION:

Designed for installation on potable water lines to protect against backsiphonage of contaminated water into the potable water supply. Assembly shall provide protection where a potential health hazard exists.

COMPLIES WITH THE FOLLOWING STANDARDS:

- ASSE® 1001
- CSA®
- IAPMO®

MATERIALS:

Main valve body: Cast Brass (1/2")
 Cast Bronze ASTM B 584 (3/4"-1")
 Elastomers: Silicone (FDA approved)
 Buna Nitrile (FDA approved)
 Polymers: ULTEM™, NSF Listed (1/2")
 Polypropylene (3/4"-1")

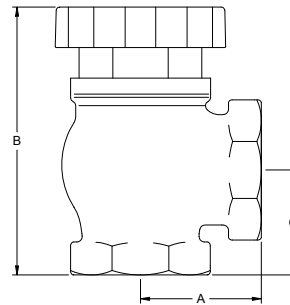
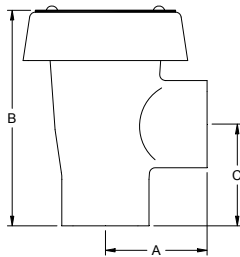

SIZE		DIMENSIONS						WEIGHT	
inch	mm	A		B		C		lbs	kg
		inch	mm	inch	mm	inch	mm		
1/2	15	1-5/16	33	2-5/8	67	1-1/4	32	2	.9
3/4	20	1-1/2	38	2-5/8	67	1-1/2	38	2	.9
1	25	1-5/8	41	3-13/16	97	1-5/16	33	2	.9

FLOW CHARTS

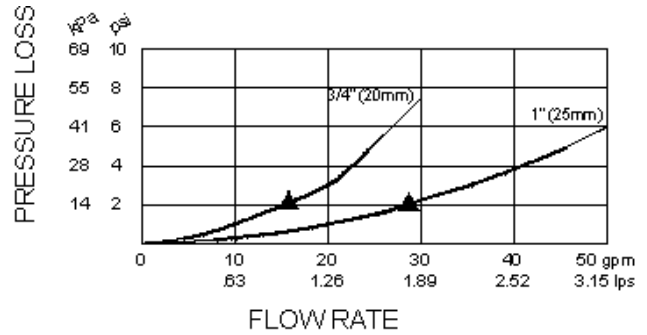
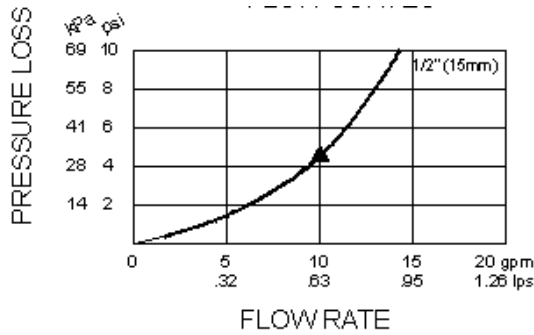

TYPICAL INSTALLATION:
FAILURE TO FOLLOW THESE INSTRUCTION WILL VOID ANY WARRANTY

Local codes shall govern installation requirements. To be installed in accordance with the manufacturer's instructions and the latest edition of the Uniform Plumbing Code. Unless otherwise specified, the assembly shall be mounted at a minimum of 6" (150mm) above the highest point of discharge with sufficient side clearance for maintenance. Because the Model GFAVB is not to be used under continuous pressure never place a shut-off or check valve downstream of the device. The installation shall be made so that no part of the unit can be submerged.

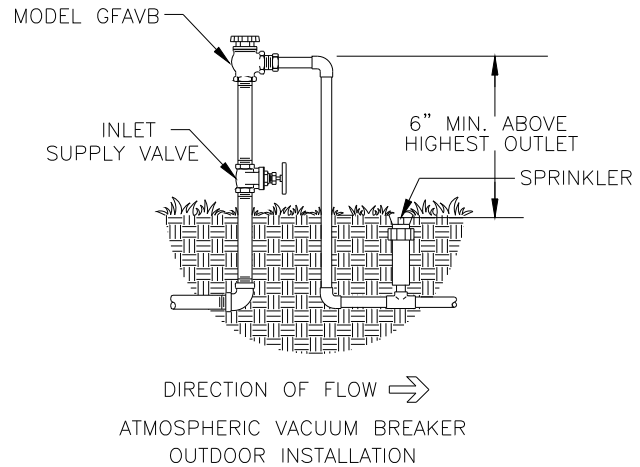
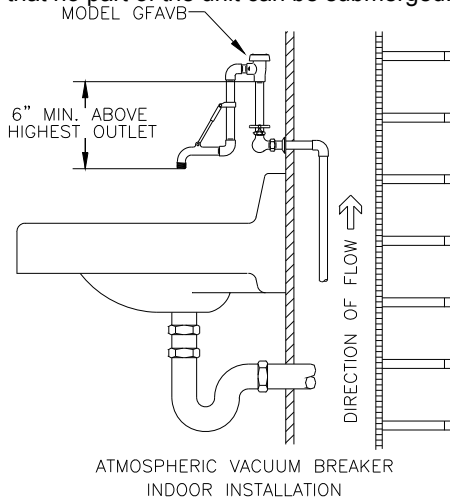

SPECIFICATIONS:

The Atmospheric Vacuum Breaker shall be ASSE® Listed 1001. The main body shall be cast bronze (3/4" thru 1"), and cast brass 1/2". All internal polymers shall be NSF® Listed ULTEM™ or polypropylene and the seat disc elastomers shall be Silicone. The device shall be accessible for maintenance without removing the device from the service line. The installation shall not be in a concealed or inaccessible location, or where the venting of water from the device, during normal functioning, may be deemed objectionable. The AVB shall be a Glen-Flo® Model GFAVB.

WARRANTY: Glen-Flo® valves are guaranteed against defects of materials or workmanship when used for the services recommended. If in any recommended service, a defect develops due to material or workmanship, and the device is returned, freight prepaid, to Flomatic Corporation within 12 months from the date of purchase, it will be repaired or replaced free of charge. Flomatic Corporation's liability shall be limited to our agreement to repair or replace the valve only.